

BATTERY OPERATED PASSIVE INFRARED DETECTOR
RX CORE SERIES
RXC-RST

EN INSTALLATION INSTRUCTIONS

- FR CONSIGNES D'UTILISATION
- DE INSTALLATIONSANLEITUNG
- IT ISTRUZIONI INSTALLAZIONE
- ES INSTRUCCIONES DE INSTALACIÓN
- PT INSTRUÇÕES DE INSTALAÇÃO

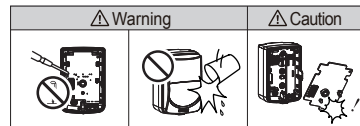

The nix sign indicates prohibition.

1 PARTS IDENTIFICATION

- FR Identification des pièces
- DE Teilekennzeichnung
- IT Descrizione delle parti
- ES Identificación de las partes
- PT Identificação das partes

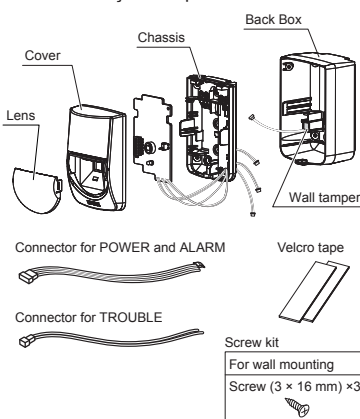

2 INSTALLATION HINTS

- FR Conseils d'installation
- DE Installations-Tipps
- IT Indicazioni installazione
- ES Recomendaciones de instalación
- PT Dicas de instalação

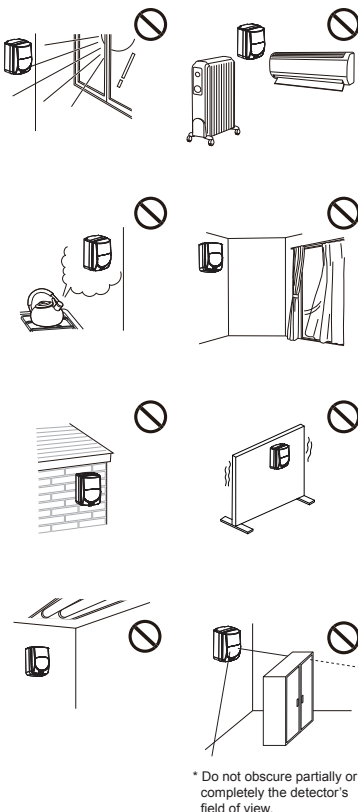

Note>>

RXC-RST shall be mounted in a position where expected intrusion is in perpendicular the detection patterns.

3 INSTALLATION

- FR Installation
- DE Installation
- IT Installazione
- ES Instalación
- PT Instalação

3-1 WIRELESS TRANSMITTER PREPARATION

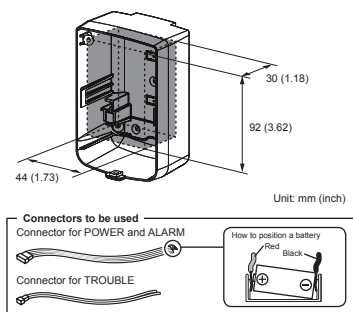

3-2 WIRING DIAGRAM

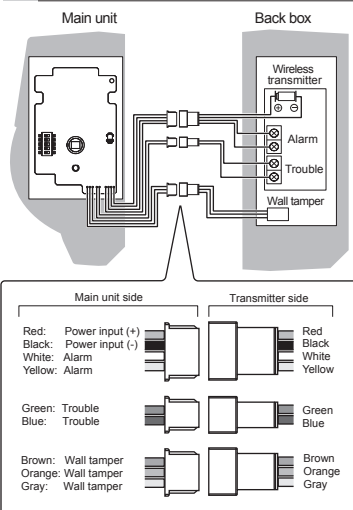

3-3 MOUNTING

1 Remove the cover.

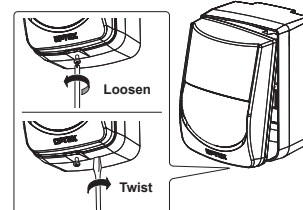

2 Remove the board.

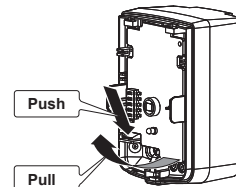

3 Separate the chassis from the back box.

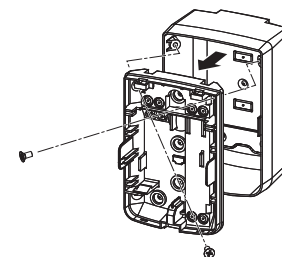

4 Mount the back box to the wall.

Backside mounting >>

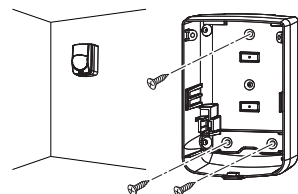

Corner mounting >>

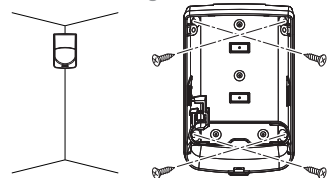

Note>>
Mounting screws are not included.

5 Mount the Wireless transmitter to the backbox or backside of the chassis.

Back box >>

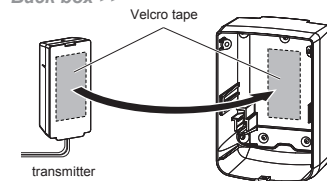

Backside of the chassis >>

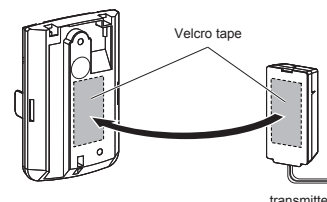

4 DETECTION ZONE

- FR Zone de détection
- DE Erfassungsbereich
- IT Zona di rilevazione
- ES Zona de detección
- PT Zona de detecção

■ TOP VIEW

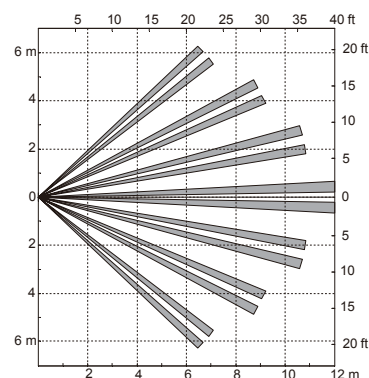

■ SIDE VIEW

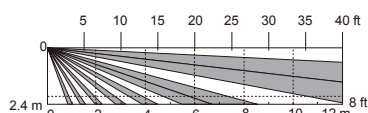

5 SWITCH SETTING

- FR Reglages des interrupteur DIP
- DE Schaltereinstellungen
- IT Impostazione dei selettori
- ES Ajuste del conmutador DIP
- PT Ajuste da chave DIP

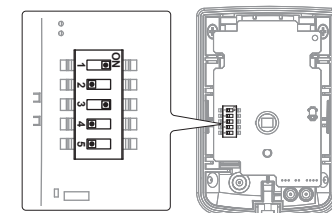

- DIP switch
- 1 WALK TEST MODE
 - 2 LED
 - 3,4 PIR SENSITIVITY
 - 5 ALARM & TROUBLE OUTPUT

-WALK TEST MODE DIP switch 1

POSITION	FUNCTION
TEST (Factory default)	The LED lights irrespective of the DIP switch 2 (LED) setting.
NORM	The LED lights depending on the DIP switch 2 (LED) setting.

NORM ⇔ TEST

Note>>
Once any output is activated, the battery saving circuit requires 2 minutes of inactivity before the next output.

-LED DIP switch 2

POSITION	FUNCTION
ON	LED ON
OFF (Factory default)	LED OFF Note>> If the LED lights, check the DIP switch 1 (WALK TEST MODE) setting.

OFF ⇔ ON

-PIR SENSITIVITY DIP switch 3,4

POSITION	FUNCTION
Low sensitivity	
Middle sensitivity (Factory default)	
High sensitivity	
Super High sensitivity	

-ALARM & TROUBLE OUTPUT DIP switch 5

POSITION	FUNCTION
N.O.	N.O. output
N.C. (Factory default)	N.C. output

N.C. ⇔ N.O.

